

Econo-Finish® Blast Cabinets

• Economical Systems for Light-Duty Stripping, Cleaning and Finishing

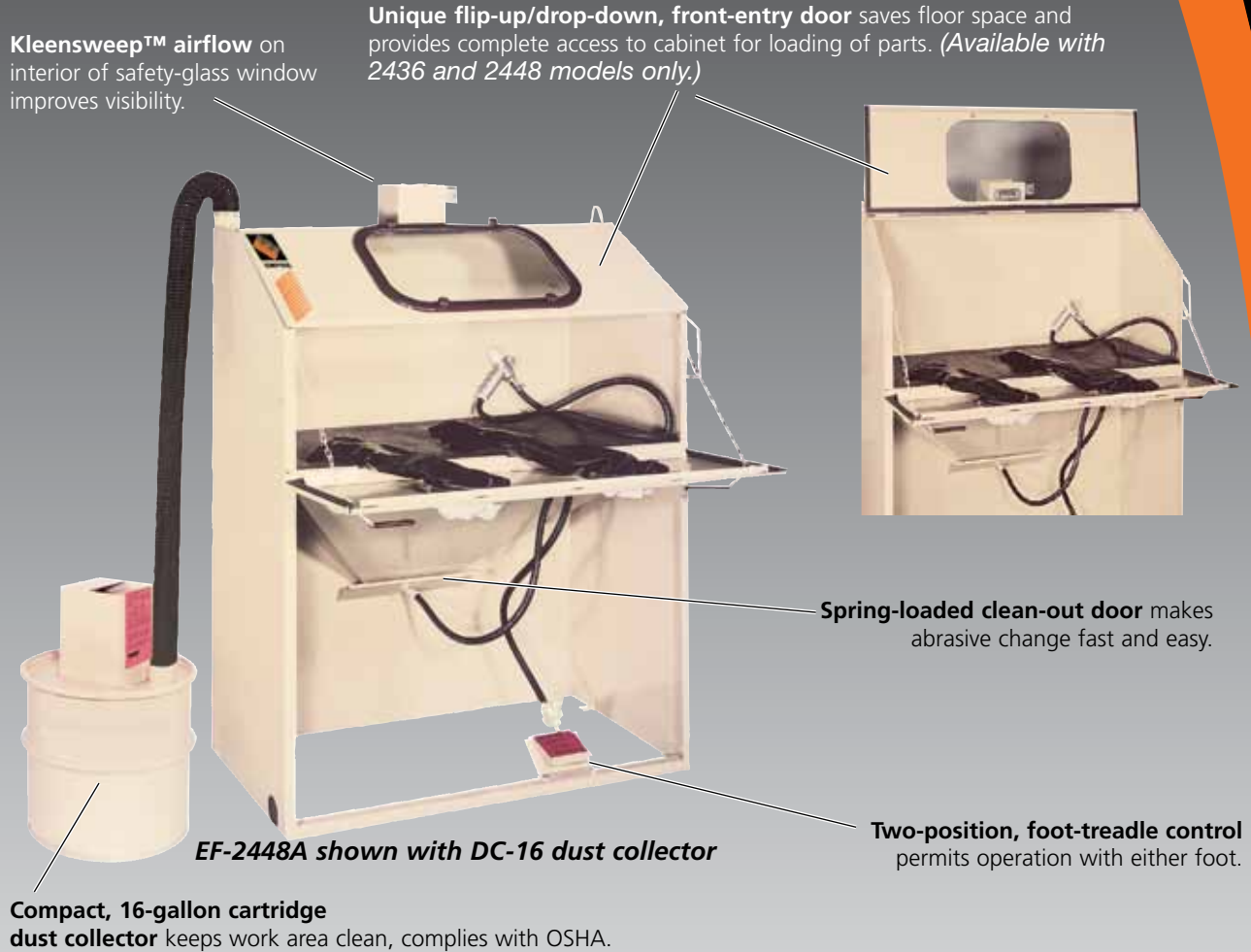

Kleensweep™ airflow on interior of safety-glass window improves visibility.

Unique flip-up/drop-down, front-entry door saves floor space and provides complete access to cabinet for loading of parts. *(Available with 2436 and 2448 models only.)*

Spring-loaded clean-out door makes abrasive change fast and easy.

Two-position, foot-treadle control permits operation with either foot.

EF-2448A shown with DC-16 dust collector

Compact, 16-gallon cartridge dust collector keeps work area clean, complies with OSHA.

Empire's inexpensive Econo-Finish® blast cabinets feature a unique front-access door to simplify loading of parts, save floor space and speed finishing operations.

Designed for light-to-medium cleaning and surface-finishing jobs, these economical cabinets combine sturdy, 14-gauge steel construction with the features you need to perform a wide range of finishing tasks. All Econo-Finish cabinets are equipped with a foot-treadle blast control for ease of operation, an external media-regulation device, quick-change safety glass and a dust-collection system.

In addition, you can select from upgraded features such as production-quality blast guns, a pressure regulator with gauge, long-life blast nozzles and a high-capacity dust collector that extends operating intervals between clean-outs. Our DC-16 and DC-30 dust collectors feature a cartridge filter with 16-gallon and 30-gallon dust capacities and built-in silencers.

Econo-Finish cabinets are available in two basic configurations: models with two-piece, swing-down and flip-up doors for maximum interior access (shown above) and an even more economical unit with a swing-down door only. Models with two-piece doors can be specified with a standard upgrade package designed to extend usage and maximize production.

To find out more about the best bargain in abrasive blast cabinets, go to the next page, contact Empire or your Empire distributor, and visit our web site at www.empire-airblast.com

Starter Systems

Empire's model EF-2430B blast cabinet provides an great opportunity for first-time blast-finishers to appreciate the capabilities of abrasive blasting.

The basic design of this cabinet is the same as other Econo-Finish models, but to further reduce costs, a single drop-down door is used.



EF-2430B shown

Compressed Air Requirements (SCFM)

Operating Pressure	40 psi	60 psi	80 psi	100 psi
MH-4 (1/4" nozzle, 3/32" air jet)	7	10	12	15
MH-2A (1/4" nozzle, 1/8" air jet)	12	17	21	26

To determine the SCFM your compressor can produce, use the following guideline: 1 horsepower = approximately 4 SCFM of air.

Different nozzles and air-jet sizes are available to broaden blast patterns, increase finishing rates or conserve compressed air. Consult your distributor and the air-requirement chart for appropriate nozzle and compressor sizes.

Before ordering, consult your local Distributor for application considerations that may affect the performance of your system.

Specifications by Model Number

(Dimensions in inches)	EF-2430B	EF-2436A	EF-2448A
Model Number	EF-2430B	EF-2436A	EF-2448A
Part Number	114013	115011	116011
Overall Dimensions (DxWxH)	24 x 30 x 65	24 x 36 x 65	24 x 48 x 65
Interior Dimensions (DxWxH)	24 x 30 x 23	24 x 36 x 23	24 x 48 x 23
Door Opening (WxH)	29 x 14	35 x 23	47 x 23
Door Type	Single	Double	Double
Weight (B Series)	215 lbs.	235 lbs.	275 lbs.
Weight (A Series)	—	285 lbs.	325 lbs.

Specifications by Series

(Dimensions in inches)	"B" Series (basic unit)	"A" Series (upgrade)
Cabinet construction	Heavy, 14-gauge steel	
Floor capacity	200 lbs.	
Gloves	Rubber, cloth lined, 8" diameter	
Blasting system	Suction, foot treadle	
Piping string	3/8"	
Nozzle material	Ceramic	
Media regulator	SAR-3	
Blast gun	MH-4	MH-2A
Pressure regulation/gauge	Option	Standard
Window safety glass	14 x 22 with quick-change frame	
Lighting	Floodlight, 90 watts	
Dust collector	DC-16 (16 gal.)	DC-30 (30 gal.)
Filter area	22 square feet	55 square feet
Collector dimensions (Diameter x Height)	16 x 22	16 x 39
Fan silencer/dBA	Standard/85	
Motor/Fan	0.98 hp/133 CFM	
Electrical system	115V, 50-60 Hz, Single Phase	

Partial listing of options available for all models: OSHA Safety door switch, Safety matting, Special electricals, Pressure regulator, Air gauge, Di-Carb™ and Boron nozzles.

Empire Air-Blast Products

- A complete range of cabinets
- Robotic, turntable and in-line automation
- Blast rooms and blast booths
- Portable blasters
- A full line of parts and accessories

**NEVER USE SILICA SAND IN ANY
EMPIRE EQUIPMENT**

Information subject to change without notice.

Empire Abrasive Equipment

2101 W. Cabot Boulevard, Langhorne, PA 19047-1893

Call: 215.752.8800 • Fax: 215.752.9373

Email: Airblast@empire-airblast.com • Search: www.empire-airblast.com